

LEGEND

- DEVELOPMENT BOUNDARY
- CADASTRAL BOUNDARY
- - - VEGETATION BOUNDARIES
- - - EXISTING WATER
- - - EXISTING WATER TO ABANDONED
- - - EXISTING SEWER PIPE
- - - EXISTING STORM WATER TO BE ABANDONED
- - - EXISTING STORM WATER TO REMAIN
- - - EXISTING LV ELECTRICAL LINE
- - - EXISTING MV ELECTRICAL LINE
- - - LV ELECTRICAL LINE FROM BITOU
- - - MV ELECTRICAL LINE FROM BITOU
- - - EXISTING CONTOURS (0.5m INTERVALS)
- - - HEADWALL
- ⊕ EXISTING SEWER MH

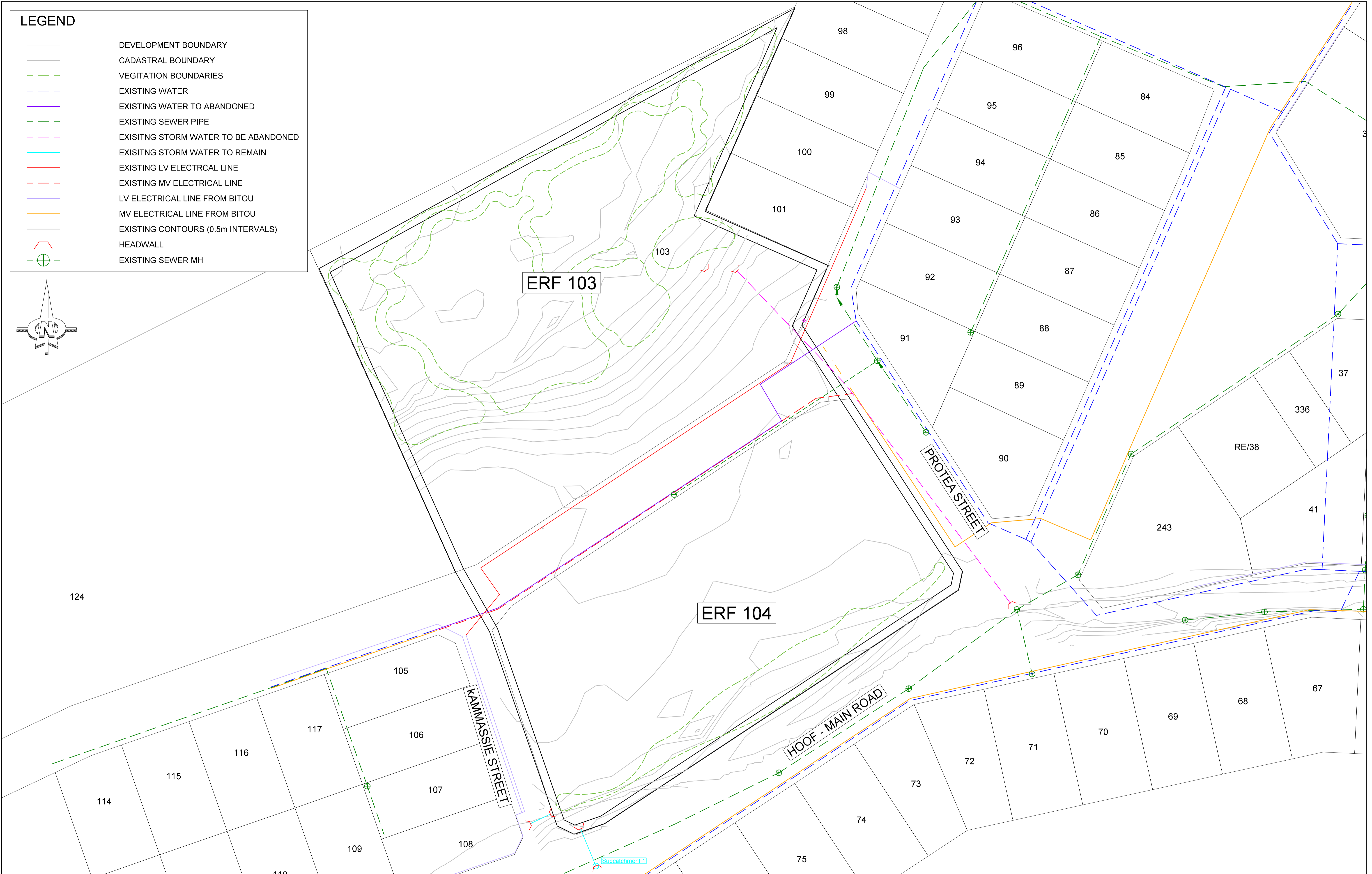
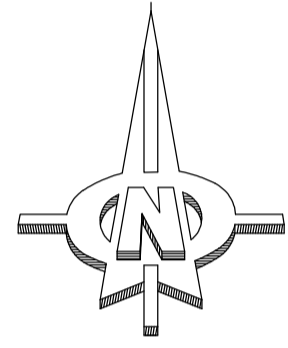

UMHLELO	AS BUILT - NOTES
INANI NO.	UMHLA DATE
TINKCAZA DESCRIPTION	IVUNYELWE APPROVED

UTSHINTSHO / AMENDMENTS	
INANI NO.	UMHLA DATE
TINKCAZA DESCRIPTION	IVUNYELWE APPROVED

UMLINGANISELO SCALE	UMLINGANISELO WOMZOBO OHLISWEYO SCALE ON REDUCED DRAWING
1: 600	50mm KUMZOBO WANGAPHAMBILI 50mm ON ORIGINAL DRAWING

UMENZI DESIGN	SM
UMZOBI DRAWN	TF
IVUNYELWE APPROVED	SM
UMHLA DATE	FEB 2020



IVUNYELWE APPROVED	IVUNYELWE APPROVED
INJINELI/ENG.	UMENZELWA / CLIENT
UMHLA / DATE	UMHLA / DATE

IVUNYELWE APPROVED	IVUNYELWE APPROVED
INJINELI/ENG.	UMENZELWA / CLIENT
UMHLA / DATE	UMHLA / DATE

The HOME Market

7 Upper Dickens Street
Central Port Elizabeth
6000
tel/fax: (041) 373 1843

IPROJETI / PROJECT	INANI LESIVUMELWANO CONTRACT NO.
PROPOSED SEVEN OAKS RETIREMENT VILLAGE, ERF 103 & 104 WITTEDRIFT	INANI LOMZOBO DWG. NO. 1692-R-001
UMZOBONKCAZA / DWG DESCRIPTION	UMHLELO ISSUE
LAYOUT PLAN AND EXISTING SERVICES	

INANI LESIVUMELWANO CONTRACT NO.
INANI LOMZOBO DWG. NO. 1692-R-001
UMHLELO ISSUE

LEGEND

- DEVELOPMENT BOUNDARY
- CADASTRAL BOUNDARY
- VEGETATION BOUNDARIES
- EXISTING WATER
- PROPOSED WATER
- PROPOSED WATER ERF CONNECTION
- EXISTING WATER TO BE RELOCATED
- PROPOSED CONTOURS (0.5m INTERVALS)
- PROPOSED WATER NODE
- PROPOSED FIRE HYDRANT

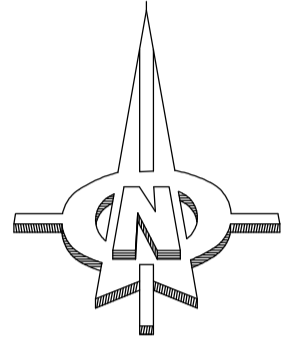

<p>"UMKHELO"</p>	<p>"AS BUILT" - NOTES</p>	<p>UTSHINTSHO / AMENDMENTS</p> <table border="1" style="width: 100%; border-collapse: collapse;"> <thead> <tr> <th>INAM NO.</th> <th>UMHLA DATE</th> <th>INKCAZA DESCRIPTION</th> <th>IVUNYELWE APPROVED</th> </tr> </thead> <tbody> <tr><td> </td><td> </td><td> </td><td> </td></tr> <tr><td> </td><td> </td><td> </td><td> </td></tr> <tr><td> </td><td> </td><td> </td><td> </td></tr> </tbody> </table>	INAM NO.	UMHLA DATE	INKCAZA DESCRIPTION	IVUNYELWE APPROVED													<p>UMLINGAN-ISELO SCALE</p> <p> 1: 600</p>	<p>UMLINGANISELO WOMZOBO OHLISWEYO SCALE ON REDUCED DRAWING</p> <p> 50mm KUMZOBO WANGAPHAMBILI</p> <p> 50mm ON ORIGINAL DRAWING</p>	<p>UMENZI DESIGN</p> <p>UMZOBI DRAWN</p> <p>IVUNYELWE APPROVED</p> <p>UMHLA DATE</p>	<p>SM</p> <p>TF</p> <p>SM</p> <p>FEB 2020</p>		<p>IVUNYELWE APPROVED</p> <p>INJINELI/ENG.</p> <p>UMHLA / DATE</p>	<p>IVUNYELWE APPROVED</p> <p>UMENZELWA / CLIENT</p> <p>UMHLA / DATE</p>	<p>7 Upper Dickens Street Central Port Elizabeth 6000 tel/fax: (041) 373 1843</p>	<p>I PROJETHI / PROJECT</p> <p>PROPOSED SEVEN OAKS RETIREMENT VILLAGE, ERF 103 & 104 WITTEDRIFT</p> <p>UMZOBONKCAZA / DWG DESCRIPTION</p> <p>WATER RETICULATION LAYOUT</p>	<p>INANI LESIVUMELWANO CONTRACT NO.</p> <p>INANI LOMZOBO DWG.NO.</p> <p>1692-R-100</p> <p>UMKHELO ISSUE</p>
INAM NO.	UMHLA DATE	INKCAZA DESCRIPTION	IVUNYELWE APPROVED																									

LEGEND

- DEVELOPMENT BOUNDARY
- CADASTRAL BOUNDARY
- - - VEGETATION BOUNDARIES
- - - EXISTING SEWER PIPES
- PROPOSED SEWER PIPES
- PROPOSED SEWER ERF CONNECTION
- PROPOSED CONTOURS (0.5m INTERVALS)
- PROPOSED SEWER MANHOLE
- ⊕ EXISTING SEWER MANHOLE

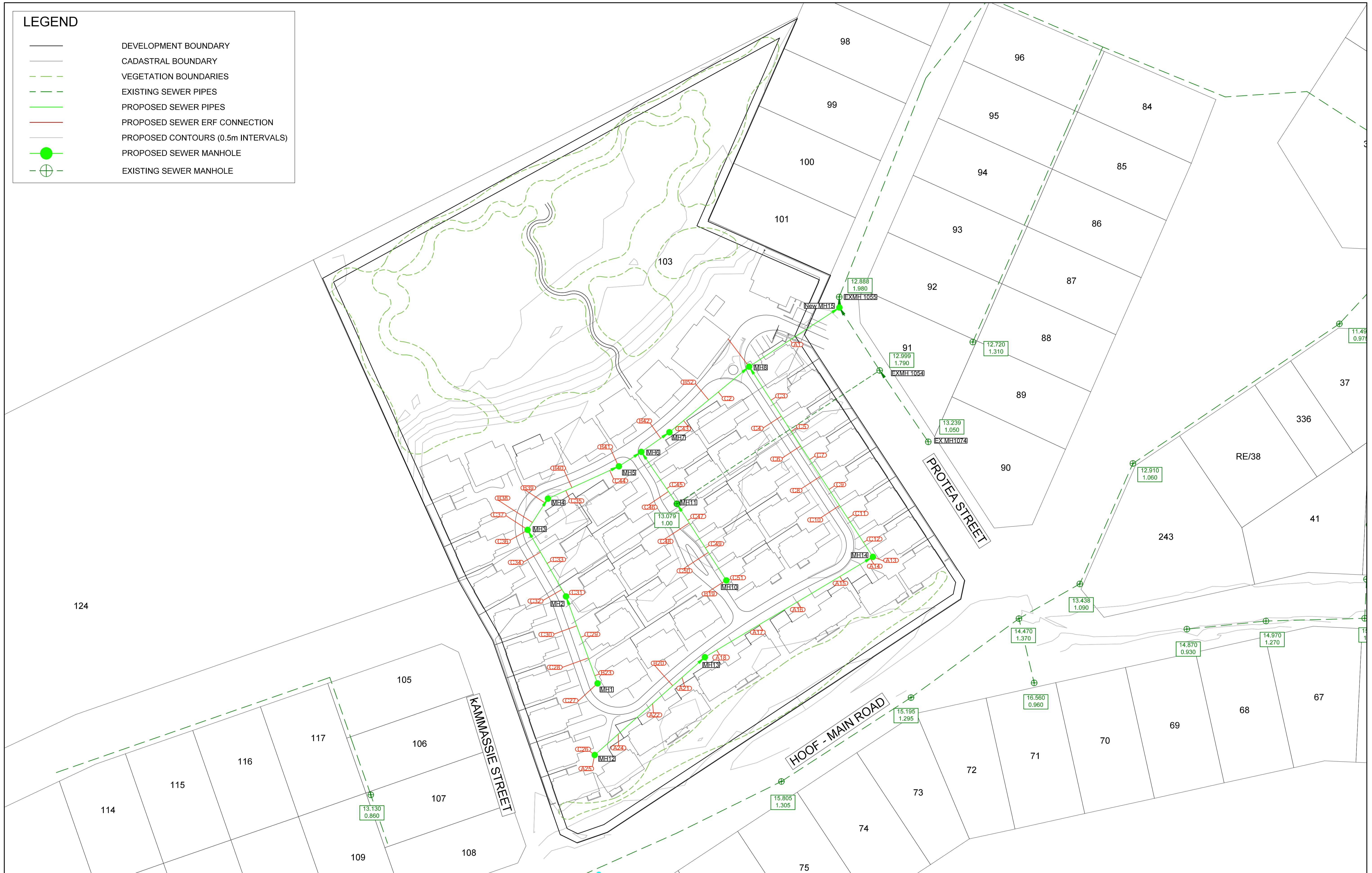

"UMKHELO"	"AS BUILT" - NOTES	UTSHINTSHO / AMENDMENTS		UMLINGAN-ISELO SCALE	UMLINGANISELO WOMZOBO OHLISWEYO SCALE ON REDUCED DRAWING	UMENZI DESIGN	SM	IVUNYELWE APPROVED	IVUNYELWE APPROVED	I-PROJETHI / PROJECT	INANI LESIVUMELWANO CONTRACT NO.
INANI NO.	UMHLA DATE	INKCAZA DESCRIPTION	IVUNYELWE APPROVED	1: 600		UMZOBHI DRAWN	TF	INJINELI/ENG.	UMENZELWA / CLIENT	PROPOSED SEVEN OAKS RETIREMENT VILLAGE, ERF 103 & 104 WITTEDRIFT	INANI LOMZOBO DWG.NO.
				m	50mm KUMZOBO WANGAPHAMBILI	IVUNYELWE APPROVED	SM	UMHLA / DATE	UMHLA / DATE	UMZOBONKCAZA / DWG DESCRIPTION	1692-R-200
				1: 600	50mm ON ORIGINAL DRAWING	UMHLA DATE	FEB 2020			SEWER RETICULATION LAYOUT	UMKHELO ISSUE



The HOME Market
 7 Upper Dickens Street
 Central Port Elizabeth
 6000
 telfax: (041) 373 1843

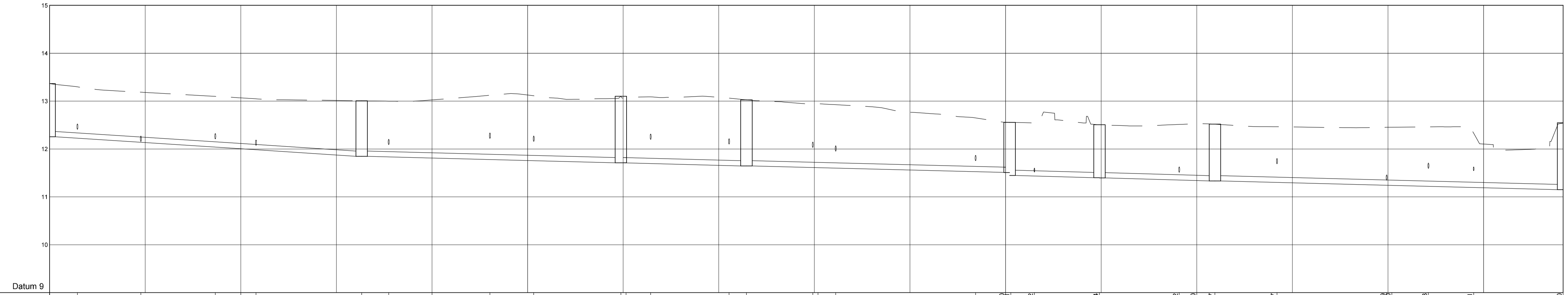

Chainage	0.000	2.909	9.546	17.331	20.000	21.592	32.045	35.489	40.000	46.059	50.843	60.927	62.871	71.075	72.896	79.833	82.228	96.882	100.000	103.012	109.824	118.162	120.000	121.887	128.387	138.858	144.228	148.051	158.320	
Manhole Name	MH1						MH2					MH3			MH4				MH5		MH6			MH7					MH8	
Ground Level	13.366	13.298	13.187	13.099	13.068	13.048	13.006	12.989	13.026	13.122	13.112	13.002	13.088	13.062	13.026	12.833	12.855	12.926	12.648	12.545	12.507	12.513	12.529	12.519	12.465	12.454	12.462	12.330	12.541	
Cover Level	13.366						13.006					13.002			13.026				12.648		12.507			12.519					12.541	
Invert Level	12.256				12.008		11.860			11.813		11.714		11.613		11.513			11.511		11.402			11.344		11.334			11.243	11.541
Depth	1.108						1.156			1.213		1.288		1.377		1.322			1.046		1.108			1.168					1.305	1.305
Length / Slope		32.847 m							27.113 m				13.138 m			27.525 m				9.404 m			12.073 m					36.424 m		
Flow		0.025 l/s							0.125 l/s				0.225 l/s			0.275 l/s				0.324 l/s			0.574 l/s					0.574 l/s		
Capacity		7.270 l/s							4.598 l/s				4.598 l/s			4.598 l/s				4.598 l/s			4.778 l/s					4.598 l/s		
Velocity		0.232 m/s							0.245 m/s				0.290 m/s			0.307 m/s				0.324 m/s			0.392 m/s					0.381 m/s		

Manhole MH1 to MH8

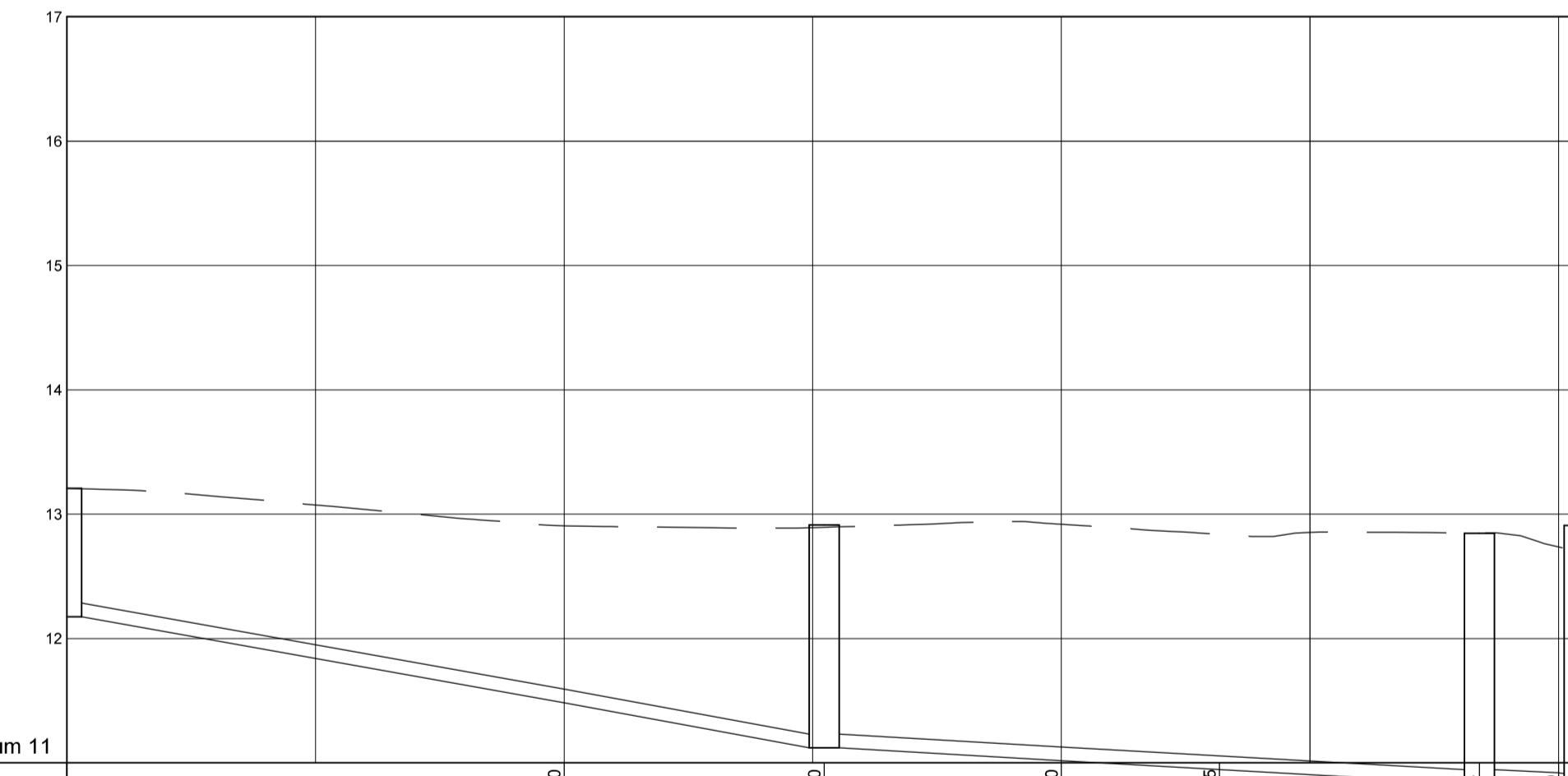

Chainage	0.000	20.000	30.450	40.000	48.355
Manhole Name	EX MH 1074		EX MH 1054		New MH 15
Ground Level				13.311	12.996
Cover Level			12.913		
Invert Level	12.078	11.485	11.123	11.019	10.805
Depth	1.031		1.790		2.010
Length / Slope		30.478 m		26.356 m	4.008 m
Flow		0.033 l/s		0.067 l/s	1.240 l/s
Capacity		12.102 l/s		6.774 l/s	5.810 l/s
Velocity		0.386 m/s		0.277 m/s	0.559 m/s

Manhole EX MH1074 to EXMH 1055

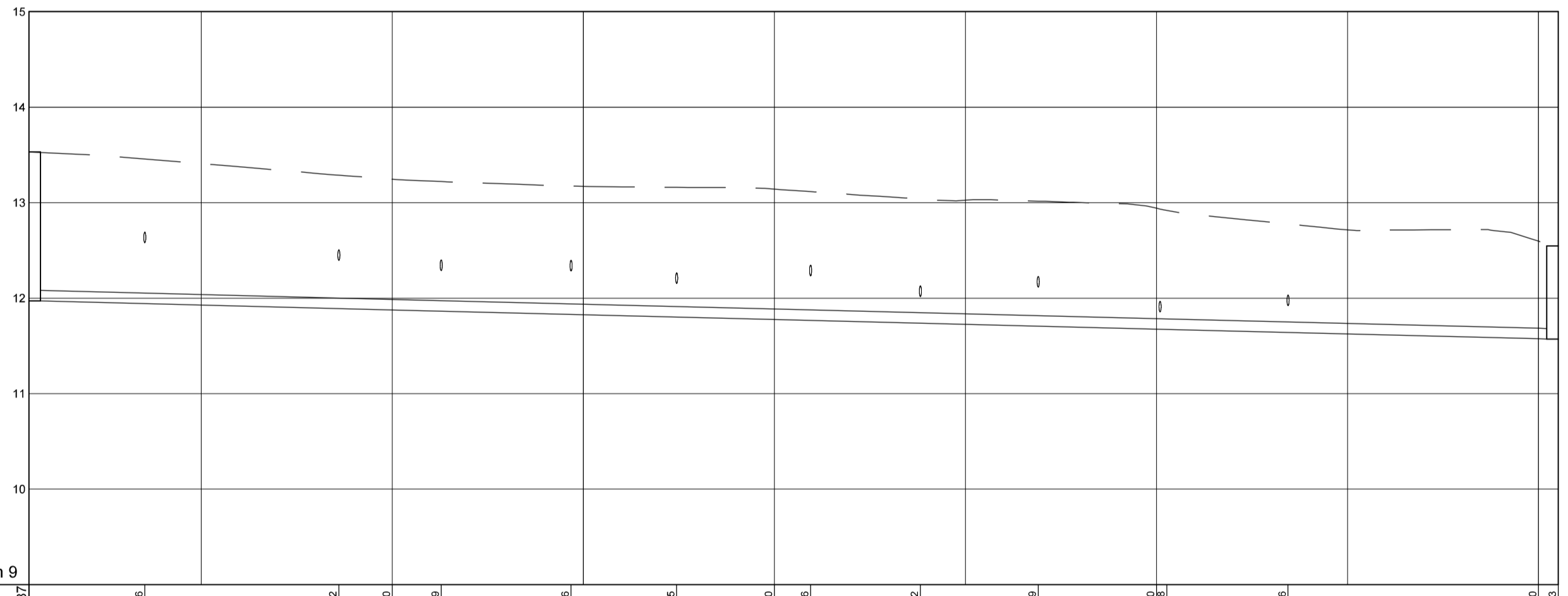

Chainage	120.887	127.248	132.202	140.000	142.859	149.395	154.885	160.000	161.896	167.542	173.899	180.000	180.000	200.000
Manhole Name	MH14													MH8
Ground Level	13.532	13.457	13.288	13.245	13.221	13.175	13.160	13.142	13.116	13.039	13.016	12.932	12.892	12.541
Cover Level														
Invert Level	13.532							11.775						11.573
Depth	1.559							1.364						1.019
Length / Slope								80.047 m						1.395
Flow								0.299 l/s						0.574 l/s
Capacity								4.598 l/s						4.598 l/s
Velocity								0.316 m/s						0.381 m/s

Manhole MH14 to MH8

"UMNKELO"	"AS BUILT" - NOTES	UTSHINTSHO / AMENDMENTS				UMLINGAN-ISELO SCALE	UMLINGANISELO WOMZOBO OHLISWEYO SCALE ON REDUCED DRAWING	UMENZI DESIGN	SM	IVUNYELWE APPROVED	IVUNYELWE APPROVED	 7 Upper Dickens Street Central Port Elizabeth 6000 tel/fax: (041) 373 1843	I PROJETHI / PROJECT	INANI LESIVUMELWANO CONTRACT NO.
		INANI NO.	UMHLA DATE	INKCAZA DESCRIPTION	IVUNYELWE APPROVED									
					1: 600	 50mm ON ORIGINAL DRAWING	IVUNYELWE APPROVED	SM					UMZOBONKCAZA / DWG DESCRIPTION	1692-R-202
							UMHLA DATE	FEB 2020					SEWER LONG SECTIONS (1 OF 3)	UMNKELO ISSUE

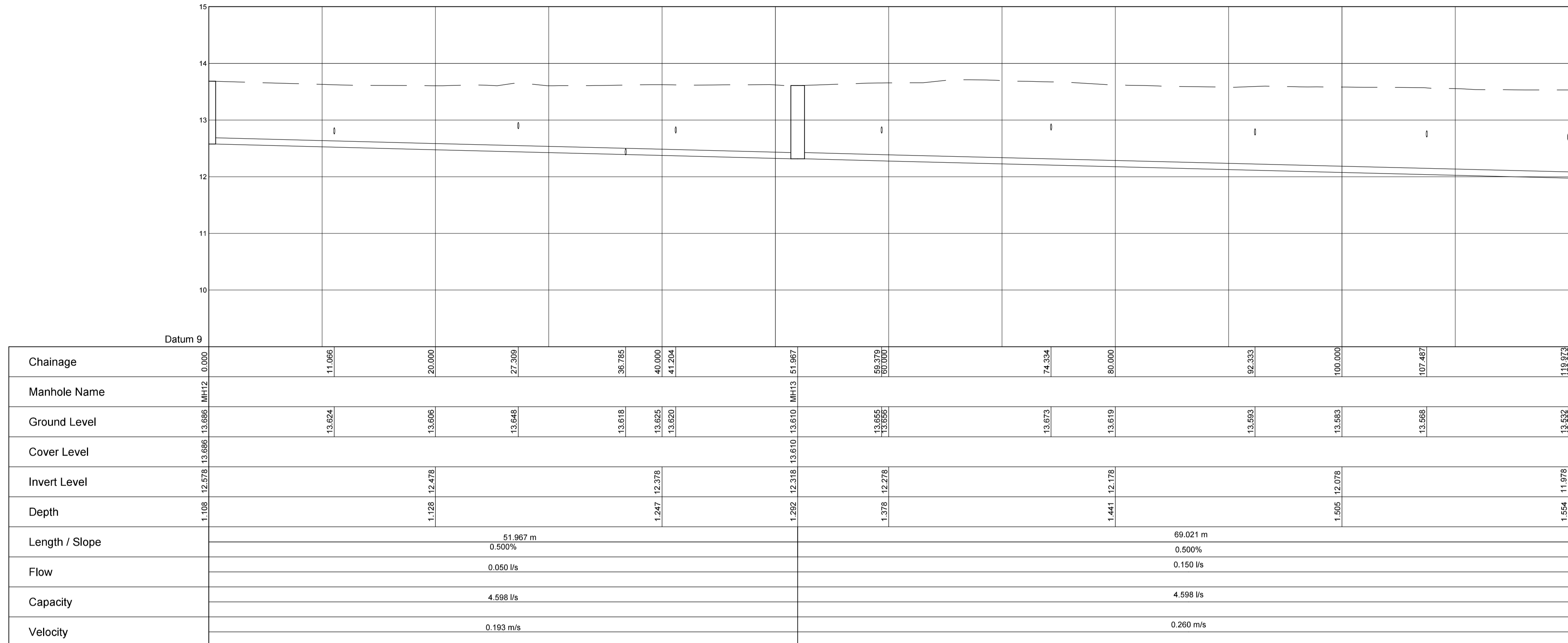

Manhole MH12 to MH14

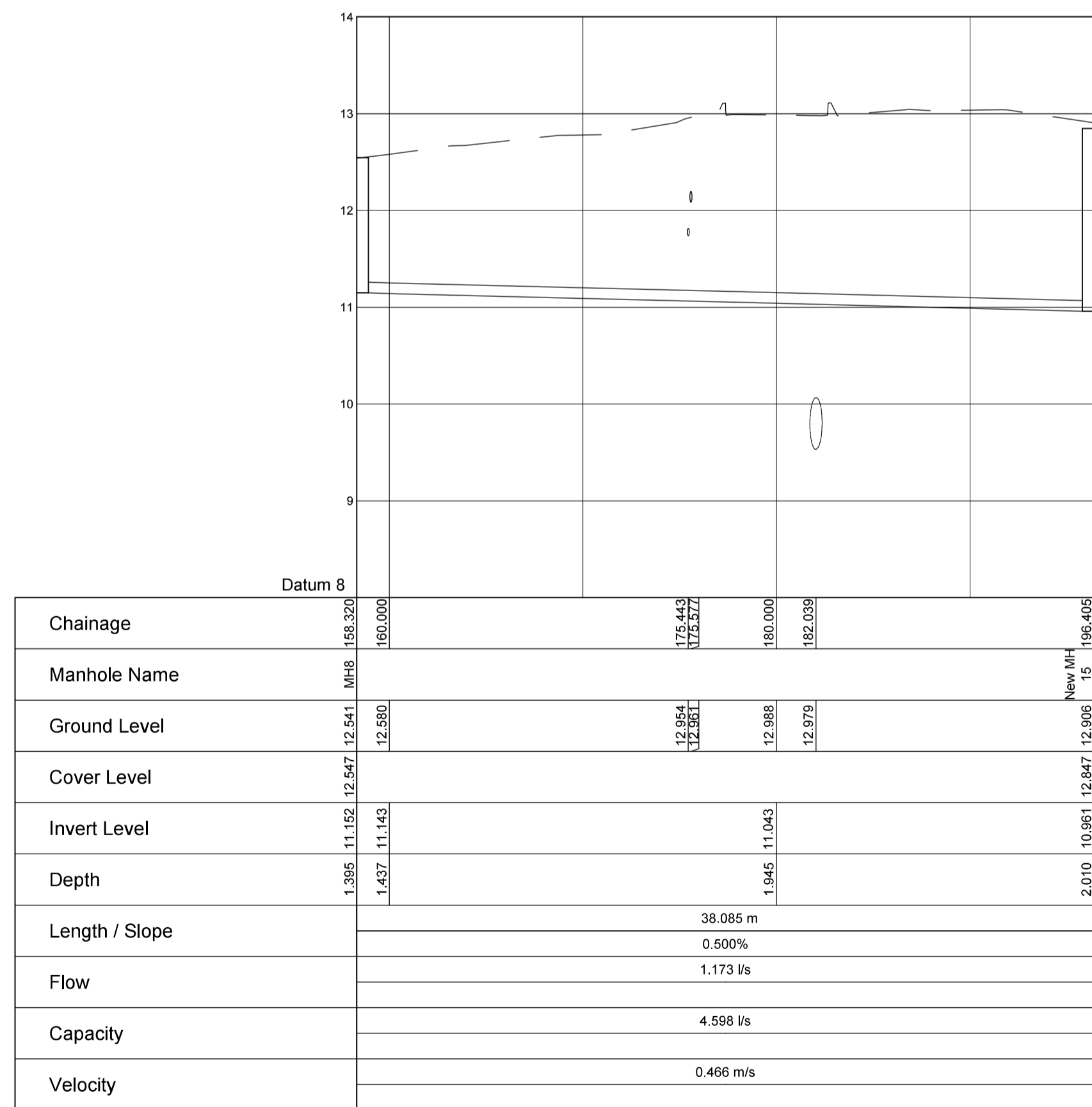



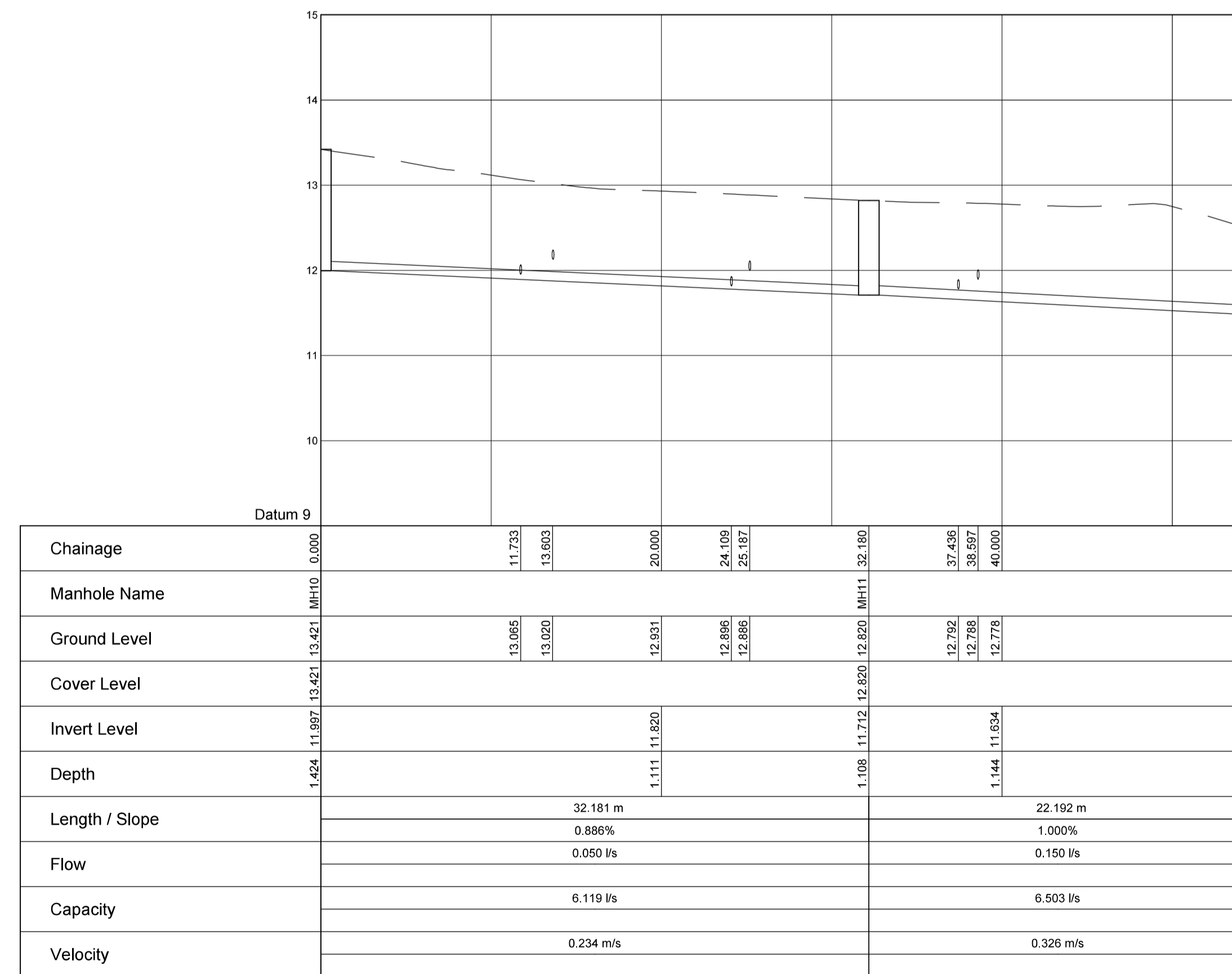



Manhole MH8 to New MH15



Manhole MH10 to MH6

"UMNIKELO"	"AS BUILT" - NOTES	UTSHINTSHO / AMENDMENTS				UMLINGAN-ISELO SCALE	UMLINGANISELO WOMZOBO OHLISWEYO SCALE ON REDUCED DRAWING	UMENZI DESIGN	SM	IVUNYELWE APPROVED	IVUNYELWE APPROVED	<p>7 Upper Dickens Street Central Port Elizabeth 6000 tel/fax: (041) 373 1843</p>	I/PROJETHI / PROJECT	INANI LESIVUMELWANO CONTRACT NO.
		INANI NO.	UMHLA DATE	INKCAZA DESCRIPTION	IVUNYELWE APPROVED									
												PROPOSED SEVEN OAKS RETIREMENT VILLAGE, ERF 103 & 104 WITTEDRIFT		INANI LOMZOBO DWG. NO. 1692-R-203
												UMZOBONKCAZA / DWG DESCRIPTION		
												UMNIKELO ISSUE		

LEGEND

-  DEVELOPMENT BOUNDARY
-  CADASTRAL BOUNDARY
-  PROPOSED ROAD
-  PROPOSED CONTOURS (0.5m INTERVALS)
-  PROPOSED SIDEWALKS
-  VEGETATION BOUNDARIES



<p>"UMKHELO"</p>	<p>"AS BUILT" - NOTES</p>	<p>UTSHINTSHO / AMENDMENTS</p> <table border="1" style="width: 100%; border-collapse: collapse;"> <thead> <tr> <th>INANI NO.</th> <th>UMHLA DATE</th> <th>INKCAZA DESCRIPTION</th> <th>IVUNYELWE APPROVED</th> </tr> </thead> <tbody> <tr><td> </td><td> </td><td> </td><td> </td></tr> <tr><td> </td><td> </td><td> </td><td> </td></tr> <tr><td> </td><td> </td><td> </td><td> </td></tr> <tr><td> </td><td> </td><td> </td><td> </td></tr> </tbody> </table>	INANI NO.	UMHLA DATE	INKCAZA DESCRIPTION	IVUNYELWE APPROVED																	<p>UMLINGAN-ISELO SCALE</p> <p></p> <p>1: 600</p>	<p>UMLINGANISELO WOMZOBO OHLISWEYO SCALE ON REDUCED DRAWING</p> <p></p> <p>50mm KUMZOBO WANGAPHAMBILI 50mm ON ORIGINAL DRAWING</p>	<p>UMENZI DESIGN</p> <p>UMZOBHI DRAWN</p> <p>IVUNYELWE APPROVED</p> <p>UMHLA DATE</p>	<p>SM</p> <p>TF</p> <p>SM</p> <p>FEB 2020</p>		<p>IVUNYELWE APPROVED</p> <p>INJINELI/ENG.</p> <p>UMHLA / DATE</p>	<p>IVUNYELWE APPROVED</p> <p>UMENZELWA / CLIENT</p> <p>UMHLA / DATE</p>	 <p>7 Upper Dickens Street Central Port Elizabeth 6000 tel/fax: (041) 373 1843</p>	<p>I PROJETHI / PROJECT</p> <p>PROPOSED SEVEN OAKS RETIREMENT VILLAGE, ERF 103 & 104 WITTEDRIFT</p> <p>UMZOBONKCAZA / DWG DESCRIPTION</p> <p>ROADS LAYOUT</p>	<p>INANI LESIVUMELWANO CONTRACT NO.</p> <p>INANI LOMZOBO DWG. NO.</p> <p>1692-R-300</p> <p>UMKHELO ISSUE</p>
INANI NO.	UMHLA DATE	INKCAZA DESCRIPTION	IVUNYELWE APPROVED																													

ROAD LIST				
POSITION	SV	Y-Coord	X-Coord	RADIUS
Start	0	-30858.56	3764643.28	0.00
BCC1	18.71	-30841.43	3764635.74	
PI1	26.22	-30833.19	3764632.12	10.83
ECC1	33.73	-30828.12	3764639.55	
BCC2	41.01	-30824.02	3764645.56	
PI2	81.40	-30800.44	3764680.15	125.00
ECC2	121.79	-30780.78	3764693.55	
BCC3	122.60	-30780.02	3764693.81	
ECC3	149.13	-30751.84	3764715.53	
BCC4	167.98	-30761.27	3764731.85	
PI4	170.99	-30762.78	3764734.46	31.75
ECC4	174.00	-30763.77	3764737.31	
PH0	398.70	-30825.21	3764648.23	

CENTRE ROAD				
POSITION	SV	Y-Coord	X-Coord	RADIUS
BCC3	49.27	-30800.17	3764701.44	
PI3	50.93	-30799.28	3764700.04	11.75
ECC3	52.59	-30798.77	3764698.44	
BCC4	54.75	-30798.14	3764696.38	
PI4	57.38	-30797.37	3764693.85	18.25
ECC4	60.00	-30795.91	3764691.64	
PI5	72.35	-30789.11	3764681.33	

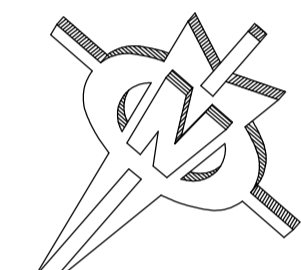

SCALE 1: 250

Chainage 0 to 160
Horizontal Scale 1: 250
Vertical Scale 1: 50

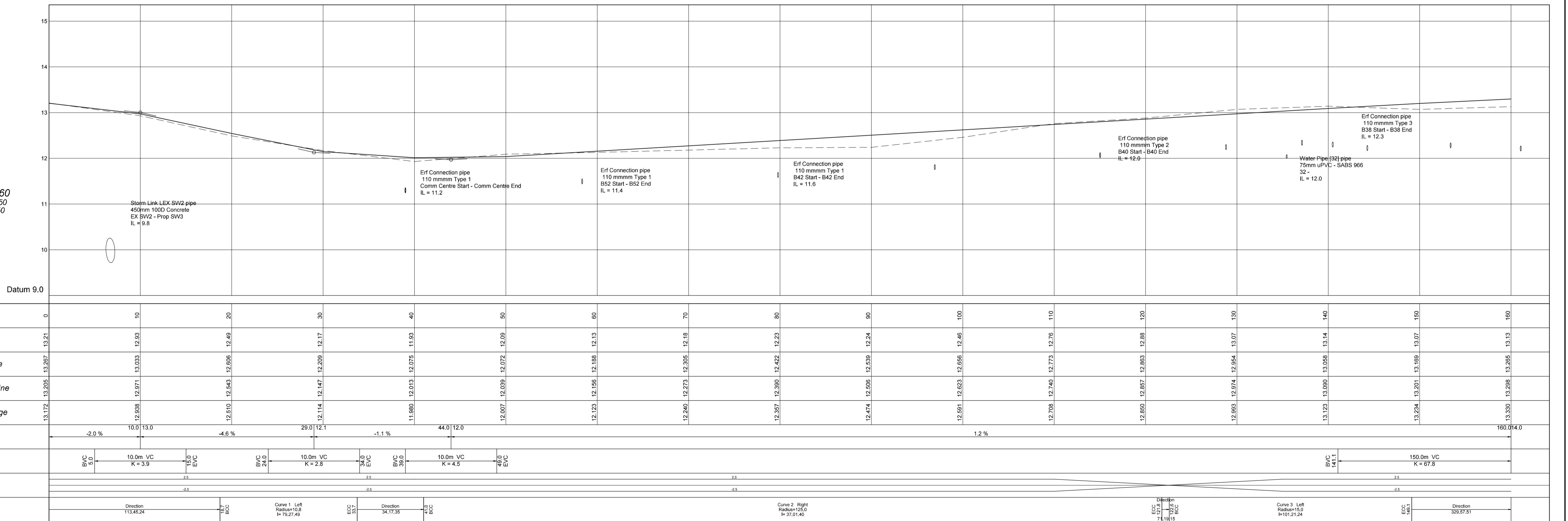

LONGSECTION CH 0 TO CH 160

"UMNKELLO"		"AS BUILT" - NOTES		UTSHINTSHO / AMENDMENTS		UMLINGAN-ISELO SCALE	UMLINGANESELO WOMZOBO OHLISWEYO SCALE ON REDUCED DRAWING	UMENZI DESIGN	SM	IVUNYELWE APPROVED	IVUNYELWE APPROVED	<p>7 Upper Dickens Street Central Port Elizabeth 6000 tel/fax: (041) 373 1843</p>	IPROJETHI / PROJECT	INANI LESIVUMELWANO CONTRACT NO.
INANI NO.	UMHLA DATE	INKCAZA DESCRIPTION	IVUNYELWE APPROVED	UMLINGAN-ISELO SCALE	UMLINGANESELO WOMZOBO OHLISWEYO SCALE ON REDUCED DRAWING	UMENZI DESIGN	UMZOBHI DRAWN	SM	IVUNYELWE APPROVED	UMENZELWA / CLIENT	UMHLA / DATE		UMHLA / DATE	PROPOSED SEVEN OAKS RETIREMENT VILLAGE, Central Port Elizabeth
												UMZOBONKCAZA / DWG DESCRIPTION	INANI LOMZOBO DWG. NO. 1692-R-301	
												ROAD LONG SECTIONS (1 OF 4)	UMNKELLO ISSUE	

ROAD LIST				
RING ROAD				
POSITION	SV	Y-Coord	X-Coord	RADIUS
BCC4	167.98	-30761.27	3764731.85	
PI4	170.99	-30762.78	3764734.46	31.75
ECC4	174.00	-30763.77	3764737.31	
BCC5	203.27	-30773.33	3764734.96	
ECC5	227.69	-30793.37	3764769.79	
BCC6	228.90	-30794.25	3764768.95	
PI6	268.90	-30823.45	3764741.11	250.00
ECC6	308.91	-30859.94	3764723.37	
BCC7	310.37	-30861.26	3764723.25	
PI7	318.48	-30871.10	3764718.60	9.49
ECC7	326.58	-30865.16	3764709.48	
CENTRE ROAD				
POSITION	SV	Y-Coord	X-Coord	RADIUS
Start	1.30	-30828.04	3764740.36	0.00
BCC1	8.22	-30824.26	3764734.56	
PI1	9.01	-30823.83	3764733.90	10.50
ECC1	9.80	-30823.30	3764733.31	
BCC2	22.05	-30815.14	3764724.17	
PI2	22.84	-30814.61	3764723.58	10.50
ECC2	23.63	-30814.18	3764722.92	

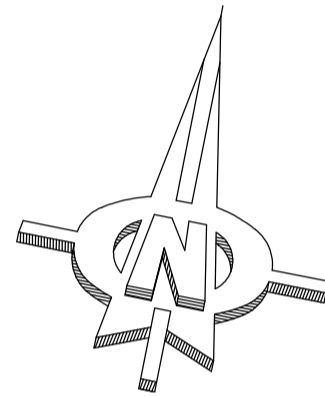

SCALE 1: 250

Chainage 160 to 320
Horizontal Scale 1: 250
Vertical Scale 1: 50

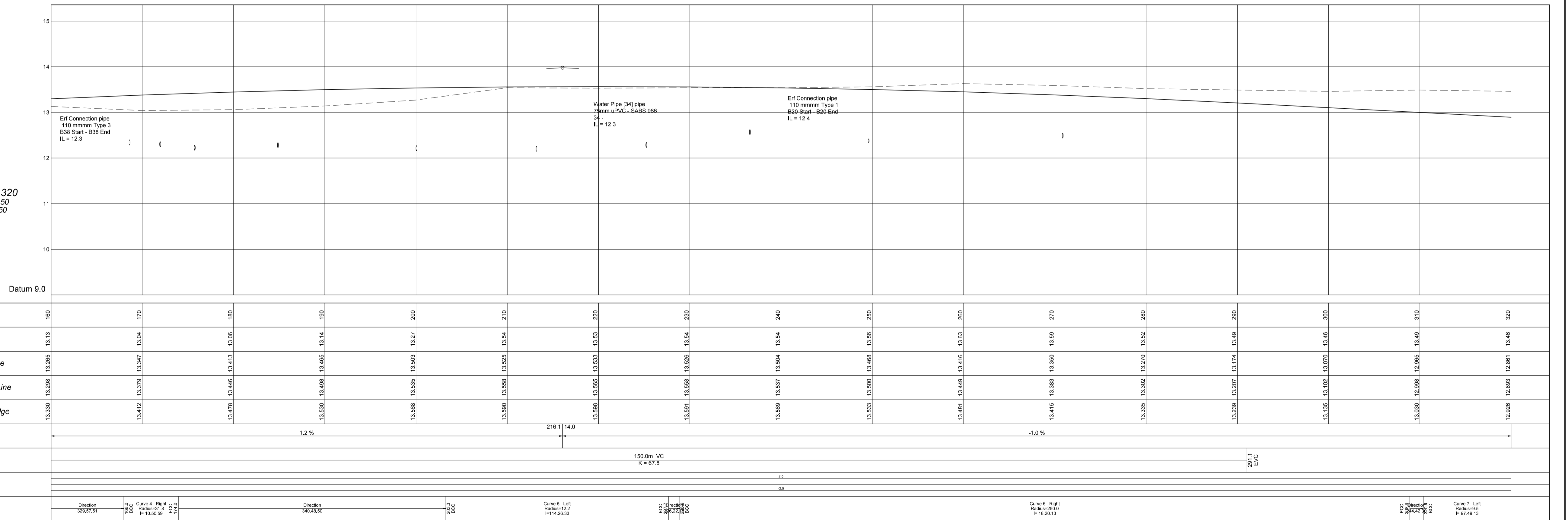

LONGSECTION CH 160 TO CH 320

"UMNKELO"		"AS BUILT" - NOTES		UTSHINTSHO / AMENDMENTS		UMLINGAN-ISELO SCALE		UMLINGANESELO WOMZOBO OHLISWEYO SCALE ON REDUCED DRAWING		UMENZI DESIGN		SM		IVUNYELWE APPROVED		IVUNYELWE APPROVED		IPROJETHI / PROJECT		INANI LESIVUMELWANO CONTRACT NO.	
INANI NO.	UMHLA DATE	INKCAZA DESCRIPTION		IVUNYELWE APPROVED		M		50mm KUMZOBO WANGAPHAMBILI 50mm ON ORIGINAL DRAWING		UMZOBHI DRAWN		TF		INJINELI/ENG.		UMENZELWA / CLIENT		7 Upper Dickens Street Central Port Elizabeth 6000 tel/fax: (041) 373 1843		PROPOSED SEVEN OAKS RETIREMENT VILLAGE, ERF 103 & 104 WITTEDRIFT	
										IVUNYELWE APPROVED		SM		UMHLA / DATE		UMHLA / DATE		UMZOBONKCAZA / DWG DESCRIPTION		INANI LOMZOBO DWG. NO. 1692-R-302	
																		ROAD LONG SECTIONS (2 OF 4)		UMNKELO ISSUE	

ROAD LIST				
Walkway				
POSITION	SV	Y-Coord	X-Coord	RADIUS
P19	84.53	-30763.63	3764600.41	3.00
ECC9	87.74	-30760.65	3764595.83	
P110	89.77	-30759.54	3764594.14	
RING ROAD				
POSITION	SV	Y-Coord	X-Coord	RADIUS
BCC1	18.71	-30841.43	3764635.74	
P11	26.22	-30833.19	3764632.12	10.83
ECC1	33.73	-30828.12	3764639.55	
BCC2	41.01	-30824.02	3764645.56	
P110	399.70	-30825.21	3764648.23	

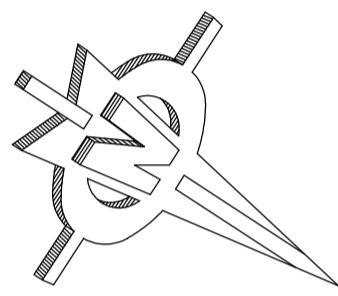
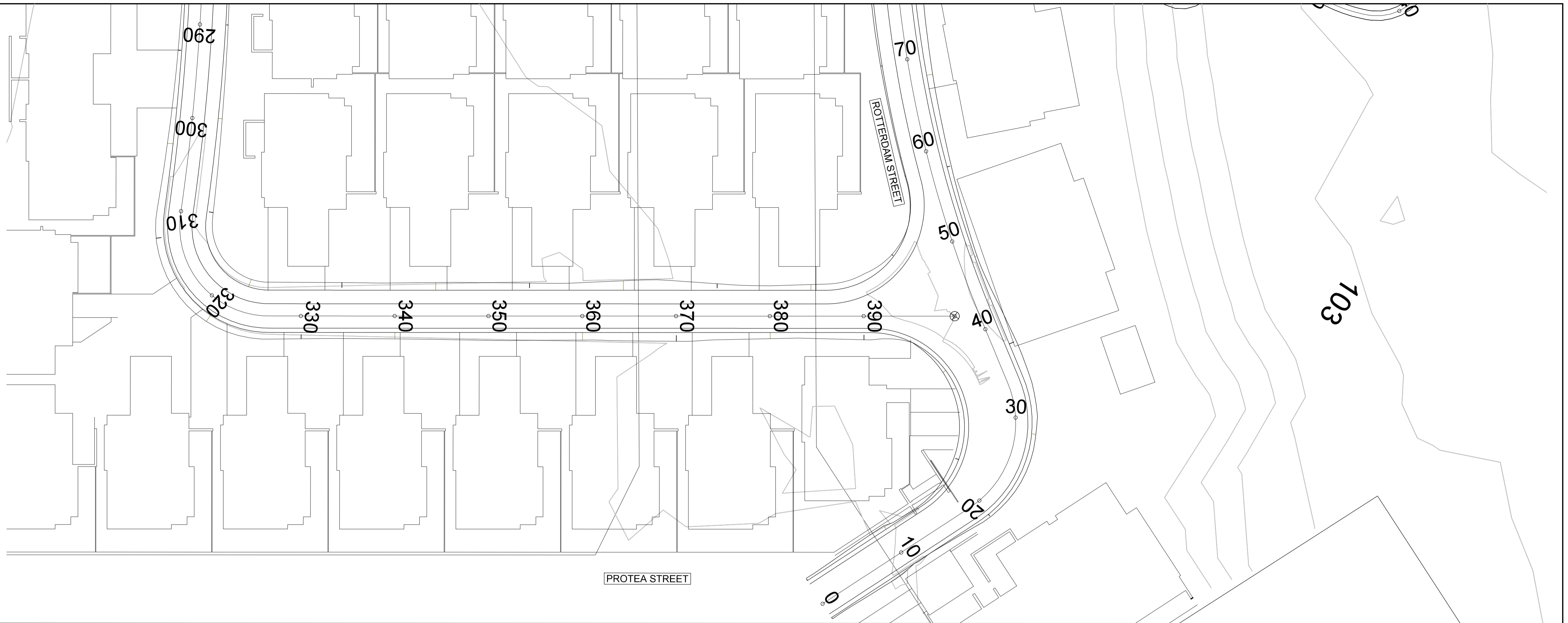

SCALE 1: 250

Chainage 320 to 399
Horizontal Scale 1:250
Vertical Scale 1:50

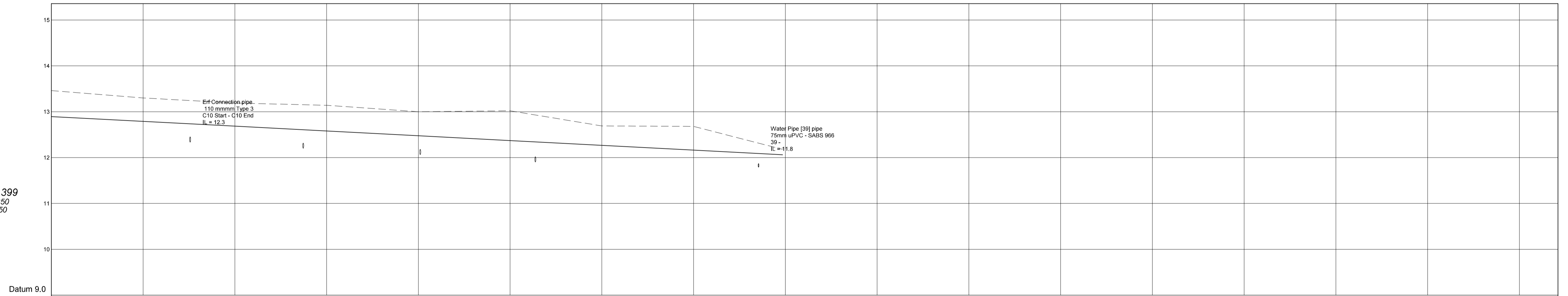

Chainage		320	330	340	350	360	370	380	390	399.70	
Centreline Peg Levels		13.46	13.30	13.19	13.14	13.00	13.02	12.69	12.68	12.18	
Vertical Alignment	Design Road Levels	Left Edge	12.891	12.795	12.652	12.548	12.443	12.339	12.234	12.134	12.001
		Centre Line	12.828	12.789	12.685	12.601	12.476	12.371	12.267	12.162	12.001
		Right Edge	12.926	12.893	12.801	12.685	12.548	12.443	12.339	12.234	12.134
Grades		-1.0 %									
Vertical Curves											
Superelevation		±±									
Horizontal Curves		Curve 7 Left Radius = 100.00 L = 97.4913 Direction 146.5317									

LONGSECTION CH 320 TO CH 399

"UMNKELO"	"AS BUILT" - NOTES	UTSHINTSHO / AMENDMENTS				UMLINGANISELO SCALE	UMLINGANISELO WOMZOBO OHLISWEYO SCALE ON REDUCED DRAWING	UMENZI DESIGN	SM	IVUNYELWE APPROVED	IVUNYELWE APPROVED		I PROJETHI / PROJECT	INANI LESIVUMELWANO CONTRACT NO.
		UMZOBHI DRAWN	TF	INJINELI/ENG.	UMENZELWA / CLIENT			PROPOSED SEVEN OAKS RETIREMENT VILLAGE, ERF 103 & 104 WITTEDRIFT						
		INKCAZA DESCRIPTION	IVUNYELWE APPROVED				IVUNYELWE APPROVED	SM				7 Upper Dickens Street Central Port Elizabeth 6000 tel/fax: (041) 373 1843	UMZOBONKCAZA / DWG DESCRIPTION	INANI LOMZOBO DWG. NO.
							UMHLA DATE	FEB 2020					ROAD LONG SECTIONS (3 OF 4)	1692-R-303

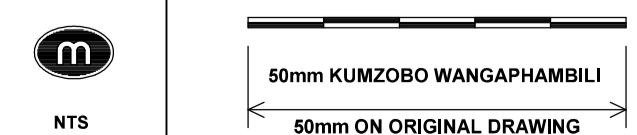

UMNKELO ISSUE

ROAD LIST				
CENTRE ROAD				
POSITION	SV	Y-Coord	X-Coord	RADIUS
PI0	0	-30789.28	3764659.30	0.00
BCC1	6.86	-30785.53	3764653.56	
PI1	9.42	-30784.06	3764651.29	6.50
ECC1	11.36	-30784.62	3764648.94	
BCC2	12.01	-30784.63	3764648.62	
PI2	14.63	-30785.33	3764645.34	3.30
ECC2	17.25	-30782.03	3764644.69	
BCC3	17.54	-30781.75	3764644.64	
PI3	23.16	-30775.02	3764643.32	7.80

RING ROAD				
POSITION	SV	Y-Coord	X-Coord	RADIUS
PI2	81.40	-30800.44	3764680.15	125.00
PI6	268.90	-30823.45	3764741.11	250.00

Road3				
POSITION	SV	Y-Coord	X-Coord	RADIUS
Start	1.30	-30828.04	3764740.36	0.00
BCC1	8.22	-30824.26	3764734.56	
PI1	9.01	-30823.83	3764733.90	10.50
ECC1	9.80	-30823.30	3764733.31	
BCC2	22.05	-30815.14	3764724.17	
PI2	22.84	-30814.61	3764723.58	10.50
ECC2	23.63	-30814.18	3764722.92	
BCC3	49.27	-30800.17	3764701.44	
PI3	50.93	-30799.26	3764700.04	11.75
ECC3	52.59	-30798.77	3764698.44	
BCC4	54.75	-30798.14	3764696.38	
PI4	57.38	-30797.37	3764693.85	18.25
ECC4	60.00	-30795.91	3764691.64	
PI5	72.35	-30789.11	3764681.33	

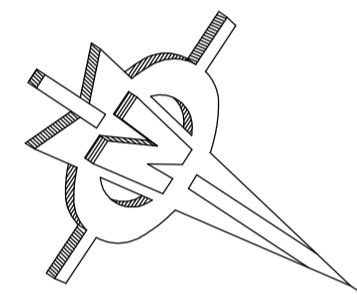

SCALE 1: 250

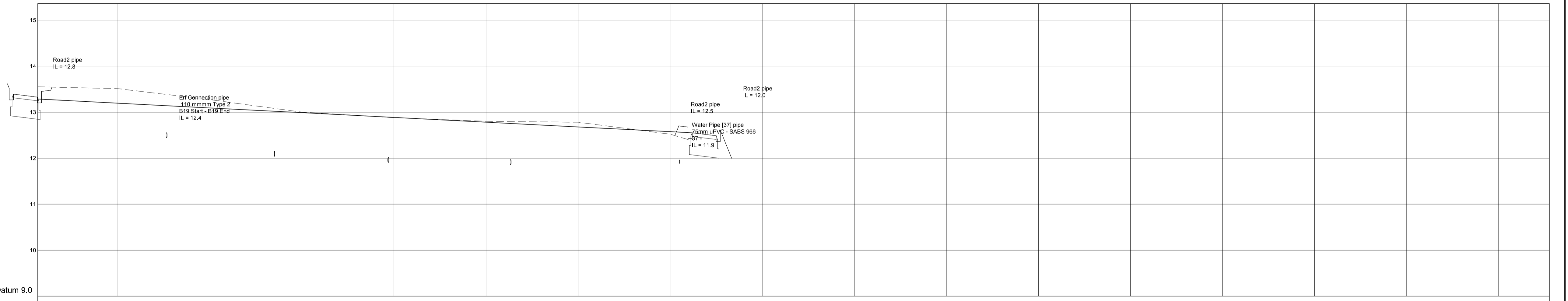

Chainage 1 to 72
Horizontal Scale 1: 250
Vertical Scale 1: 50

Datum 9.0

Chainage	1.30	10	20	30	40	50	60	70	72.35	
Centreline Peg Levels	13.55	13.51	13.27	13.00	12.88	12.80	12.78	12.52	12.38	
Vertical Alignment	Design Road Levels	Left Edge	13.320	13.224	13.149	13.096	12.920	12.885	12.621	12.38
		Centre Line	13.198	13.194	13.091	13.006	12.885	12.814	12.621	12.38
		Right Edge	13.329	13.284	13.224	13.149	13.096	12.920	12.885	12.613
Grades	-1.0 %									
Vertical Curves	--									
Superelevation	--									
Horizontal Curves	--									

LONGSECTION CH 1 TO CH 72

UTSHINTSHO / AMENDMENTS	UMLINGANISELO WOMZOBO OHLISWEYO	UMENZI DESIGN	SM	IVUNYELWE APPROVED	IVUNYELWE APPROVED	IPROJETHI / PROJECT	INANI LESIVUMELWANO CONTRACT NO.																																
<table border="1" style="width: 100%;"> <tr> <th>INANI NO.</th> <th>UMHLA DATE</th> <th>INKCAZA DESCRIPTION</th> <th>IVUNYELWE APPROVED</th> </tr> <tr> <td> </td> <td> </td> <td> </td> <td> </td> </tr> </table>	INANI NO.	UMHLA DATE	INKCAZA DESCRIPTION	IVUNYELWE APPROVED					<table border="1" style="width: 100%;"> <tr> <th>UMLINGANISELO SCALE</th> <th>UMLINGANISELO WOMZOBO OHLISWEYO SCALE ON REDUCED DRAWING</th> </tr> <tr> <td> </td> <td> </td> </tr> </table>	UMLINGANISELO SCALE	UMLINGANISELO WOMZOBO OHLISWEYO SCALE ON REDUCED DRAWING			<table border="1" style="width: 100%;"> <tr> <th>UMZOBHI DRAWN</th> <th>SM</th> </tr> <tr> <td> </td> <td> </td> </tr> <tr> <th>IVUNYELWE APPROVED</th> <th>SM</th> </tr> <tr> <td> </td> <td> </td> </tr> <tr> <th>UMHLA DATE</th> <th>FEB 2020</th> </tr> </table>	UMZOBHI DRAWN	SM			IVUNYELWE APPROVED	SM			UMHLA DATE	FEB 2020		<table border="1" style="width: 100%;"> <tr> <th>IVUNYELWE APPROVED</th> <th>IVUNYELWE APPROVED</th> </tr> <tr> <td> </td> <td> </td> </tr> <tr> <th>INJINELI/ENG.</th> <th>UMENZELWA / CLIENT</th> </tr> <tr> <td> </td> <td> </td> </tr> <tr> <th>UMHLA / DATE</th> <th>UMHLA / DATE</th> </tr> </table>	IVUNYELWE APPROVED	IVUNYELWE APPROVED			INJINELI/ENG.	UMENZELWA / CLIENT			UMHLA / DATE	UMHLA / DATE	<p>7 Upper Dickens Street Central Port Elizabeth 6000 tel/fax: (041) 373 1843</p>	<p>PROPOSED SEVEN OAKS RETIREMENT VILLAGE, ERF 103 & 104 WITTEDRIFT</p> <p>UMZOBONKCAZA / DWG DESCRIPTION</p> <p>ROAD LONG SECTIONS (4 OF 4)</p>	<p>INANI LOMZOBO DWG. NO. 1692-R-304</p>
INANI NO.	UMHLA DATE	INKCAZA DESCRIPTION	IVUNYELWE APPROVED																																				
UMLINGANISELO SCALE	UMLINGANISELO WOMZOBO OHLISWEYO SCALE ON REDUCED DRAWING																																						
UMZOBHI DRAWN	SM																																						
IVUNYELWE APPROVED	SM																																						
UMHLA DATE	FEB 2020																																						
IVUNYELWE APPROVED	IVUNYELWE APPROVED																																						
INJINELI/ENG.	UMENZELWA / CLIENT																																						
UMHLA / DATE	UMHLA / DATE																																						